



CIP and drain ports



Traceability



Third hole

### I Application

Manually operated ball valve is used with viscous liquids, liquids containing solid particles and mainly in applications requiring an unobstructed flow.

The valve is suitable for the food-processing, beverage, wine, oil, cosmetics and chemical industries.

### I Operating principle

The ball valve can be operated manually with the two position handle.

The handle blocks the valve in the "open" or "closed" position.

### I Design and features

Compact and robust design.

Two-position handle (standard).

Low pressure drops.

Half-bodies interchangeable with any type of connections.

Standard connection: clamp.

Gaskets and halves are marked for traceability.

Clamp assembly for easy maintenance.

### I Materials

Ball	AISI 304L / AISI 316L (depending on the size)
Half-bodies	AISI 316L (forged)
Clamp	AISI 304
Handle	AISI 304 / PP
Gasket	EPDM according to FDA 177.2600
Internal surface finish	$Ra \leq 0,8 \mu m$
External surface finish	Machined

### I Options

Gaskets: NBR, VMQ or FPM.

Connections: Weld, DIN, SMS, RJT, FIL-IDF, etc.

CIP and drain ports.

Third hole.



**I Technical specifications**

Available sizes	DN 1" - DN 4"	
Max. working temperature	-10 °C to +120 °C (EPDM)	14 °F to 248 °F
	+140 °C (SIP, max. 30 min)	284 °F
Max. working pressure	10 bar (DN 1" - DN 2½")	145 PSI
	8 bar (DN 3" - DN 4")	116 PSI



OPERATING TORQUE N·m	1"	1½"	2"	2½"	3"	4"
	8	10	14	15	18	25

**I General dimensions**

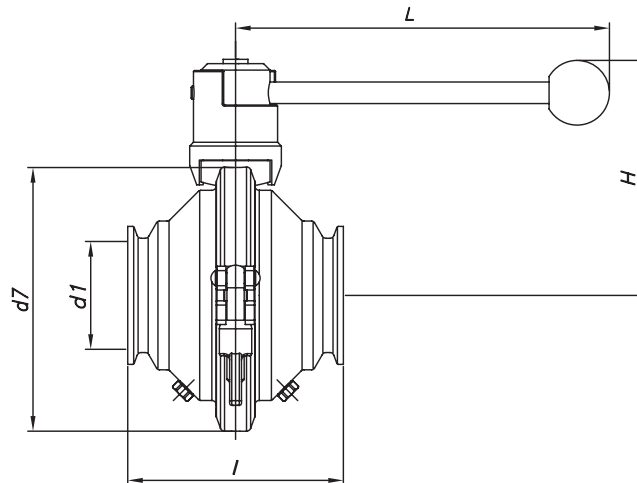

DN	d1	d7	l	H	L
DN-1"	22,1	77,5	76	95	180
DN-1 ½"	34,9	101	88	105	
DN-2"	47,6	115	102	115	
DN-2 ½" *	60,2	140	110	125	
DN-3" *	72,5	151	126	145	
DN-4"	97,4	200	166	165	

\* Material: AISI 304L



The information contained in this brochure is for guidance only. We reserve the right to modify any material or feature without notice in advance. For further information, please, consult our web site. [www.inoxpa.com](http://www.inoxpa.com)



FT.Clamp ball valve 647.2 EN-0808