

**I Application**

The NRI series agitators are medium speed vertical agitators with geared motor. These agitators can be used in processes of mixing, dissolution, dispersion, and maintenance whenever a medium or mild agitation of medium or low viscosity products is required in the food processing, cosmetics, pharmaceutical or chemical industries.

**I Operating principle**

The agitators are normally installed inside the tank either centrally with current deflectors, or offset so that the offsetting itself prevents the rotation of the stirred product. The rotation of the propeller makes the fluid flow to the bottom and then up to the surface of the product along the walls of the tank. The effect is promoted if the bottom of the tank is curved.

**I Design and features**

Vertical agitator.  
 Sealing: V-ring.  
 Propeller attached to shaft by Allen studbolts, the shaft is fixed to the gearbox by a rigid shaft flange.  
 Helical gearbox with reinforced bearings.  
 Motors: IP 55, F-class insulation.  
 Max. power 5,5 kW.  
 Marine propeller (Type 10) or propeller with inclined blades (Type 11).

**Options:**

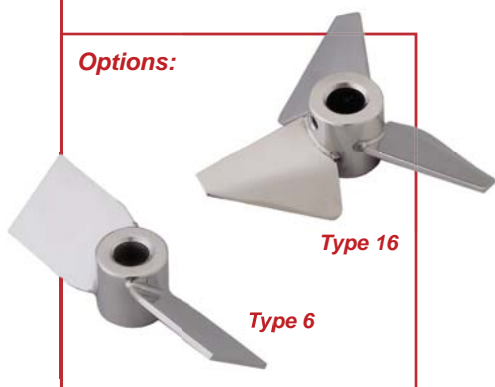

**I Materials**

Parts in contact with the product	AISI 316L
V-ring	NBR
Surface finish	Ra ≤ 0,8 μm

**I Options**

V-ring: FPM.  
 Shaft and propeller lined with plastic material for use with corrosive products.  
 Welded propeller with Ra ≤ 0,5 μm surface finish.  
 Propeller with inclined blades (Type 6) or Gamma propeller (Type 16).  
 Drive shroud.



I Technical specifications and dimensions

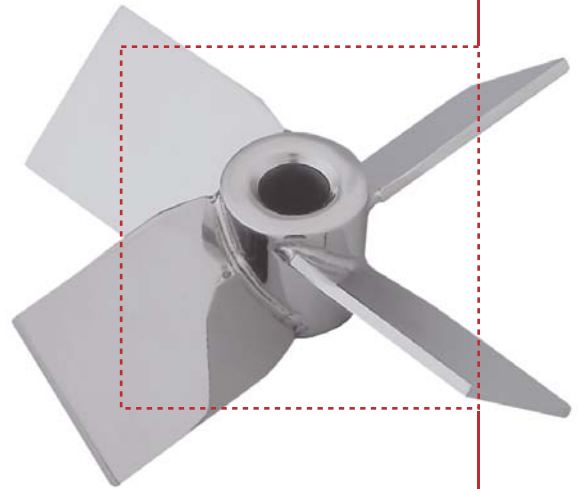
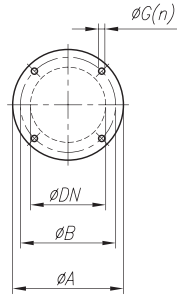
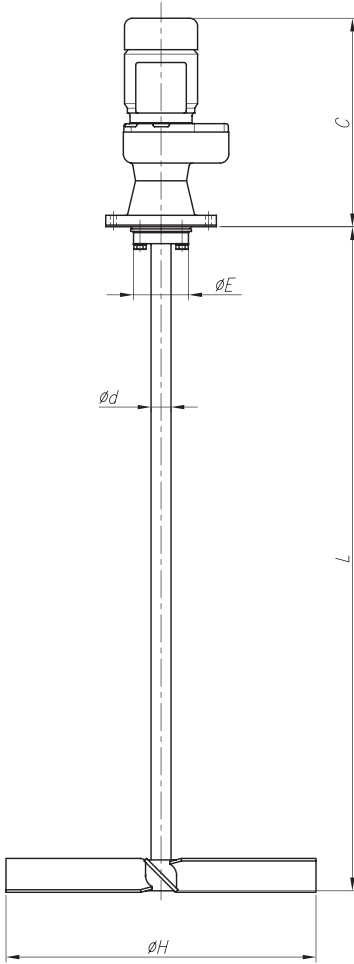

Agitator type	Motor power [kW]	Speed [rpm]	Bearing support size	Dimensions					Agitator shaft		Type			
				C	ØE	Flange			Ød	L <sub>max</sub>	ØH	ØH	Inclined blades	Marine propeller
						ØA	ØB	ØDN					ØG(n)	11
<i>NRI-B-1.11-07007-1</i>	0,75	70	B	425	105	200	165	125	11(4)	35	1800	700		
<i>NRI-C-1.11-07015-1</i>	1,5		C	520	125	250	215	150	14(4)	40	1800	800		
<i>NRI-C-1.11-07022-1</i>	2,2													
<i>NRI-D-1.11-07030-1</i>	3		D	595	140	250	215	170	14(4)	45	2000	1000		
<i>NRI-D-1.11-07040-1</i>	4													
<i>NRI-D-1.11-07055-1</i>	5,5													
<i>NRI-B-1.11-10007-1</i>	0,75	100	B	425	105	200	165	125	11(4)	35	1800	500		
<i>NRI-B-1.11-10015-1</i>	1,5		C	550	125	250	215	150	14(4)	40	1800	700		
<i>NRI-C-1.11-10022-1</i>	2,2													
<i>NRI-C-1.11-10030-1</i>	3		D	615	140	250	215	170	14(4)	45	2000	800		
<i>NRI-D-1.11-10040-1</i>	4													
<i>NRI-D-1.11-10055-1</i>	5,5													
<i>NRI-B-1.11-15007-1</i>	0,75	150	B	425	105	200	165	125	11(4)	35	1800	400		
<i>NRI-B-1.11-15015-1</i>	1,5		C	550	125	250	215	150	14(4)	40	1800	600		
<i>NRI-C-1.11-15022-1</i>	2,2													
<i>NRI-C-1.11-15030-1</i>	3		D	570	140	250	215	170	14(4)	45	2000	700		
<i>NRI-C-1.11-15040-1</i>	4													
<i>NRI-D-1.11-15055-1</i>	5,5													
<i>NRI-B-1.11-25015-1</i>	1,5	250	B	470	105	200	165	125	11(4)	35	1800	300		
<i>NRI-C-1.11-25022-1</i>	2,2		C	550	125	250	215	150	14(4)	40	1800	400		
<i>NRI-C-1.11-25030-1</i>	3													
<i>NRI-C-1.11-25040-1</i>	4		D	570	140	250	215	170	14(4)	45	2000	525		
<i>NRI-D-1.11-25055-1</i>	5,5													
<i>NRI-B-1.10-25007-1</i>	0,75												B	470
<i>NRI-B-1.10-25015-1</i>	1,5													
<i>NRI-B-1.10-25022-1</i>	2,2													
<i>NRI-C-1.10-25030-1</i>	3													
<i>NRI-D-1.10-25040-1</i>	4													
<i>NRI-D-1.10-25055-1</i>	5,5													

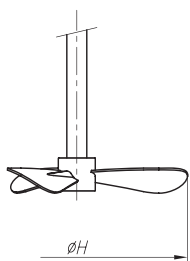

The information contained in this brochure is for guidance only. We reserve the right to modify any material or feature without notice in advance. For further information, please, consult our web site. [www.inoxpa.com](http://www.inoxpa.com)

